

Nicollet Ave Bridge over Minnehaha Creek - Historic Bridge Rehabilitation Project -

Welcome!

Where do you live?

Place a () dot on the map where you live. This helps project staff and you see who we've reached with today's open house.

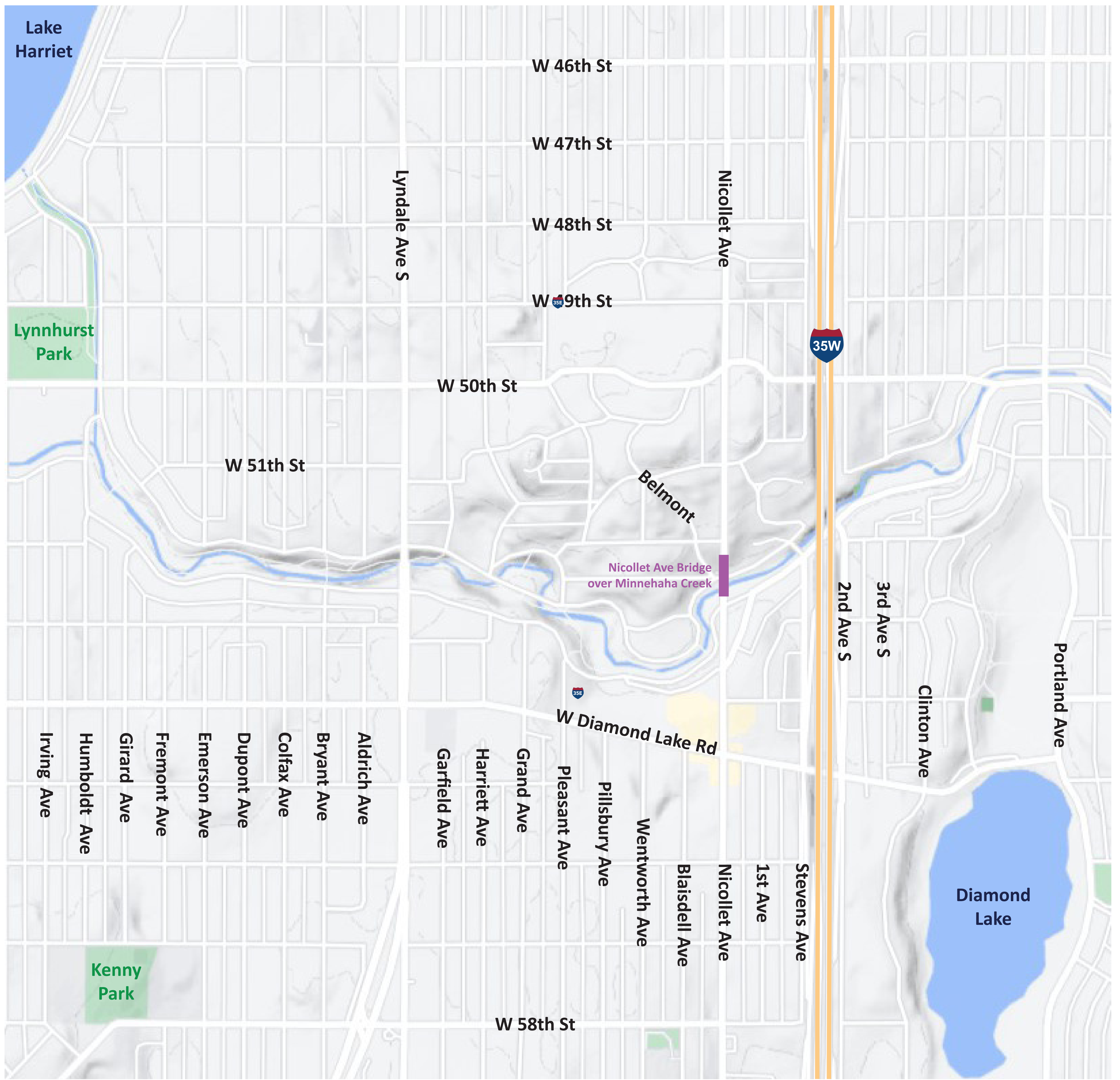

Nicollet Ave Bridge over Minnehaha Creek - Historic Bridge Rehabilitation Project -

Project Location Map



Project Information, Schedule & Funding



- Project includes rehabilitation of the bridge, 30 feet of roadway on the south approach, and 50 feet of roadway on the north
- Bridge is eligible for listing in the National Register of Historic Places
- Construction will begin when funding is secured
- Construction will take approximately 18 months

Existing Bridge Cross Section

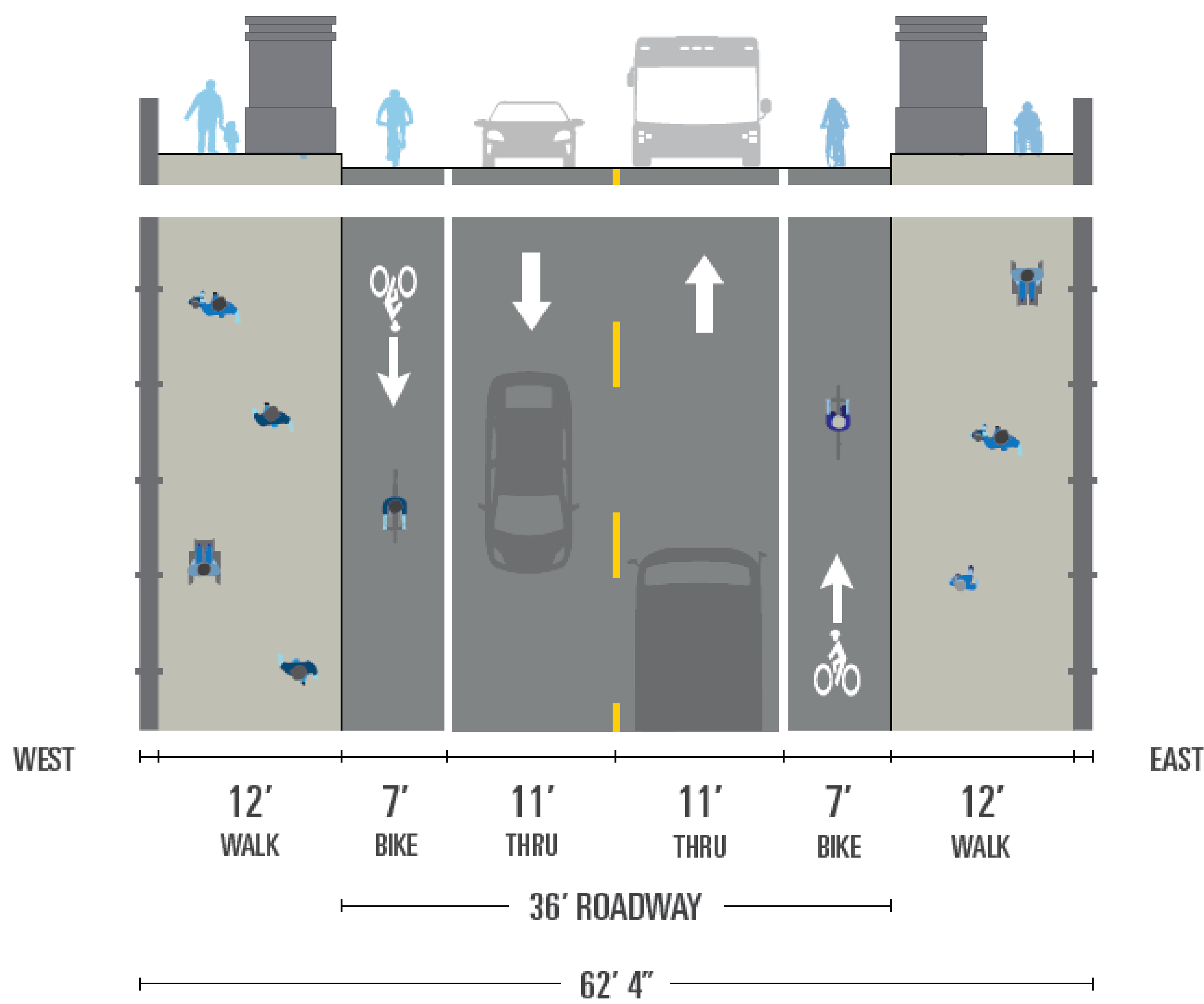

Proposed Bridge Cross Section

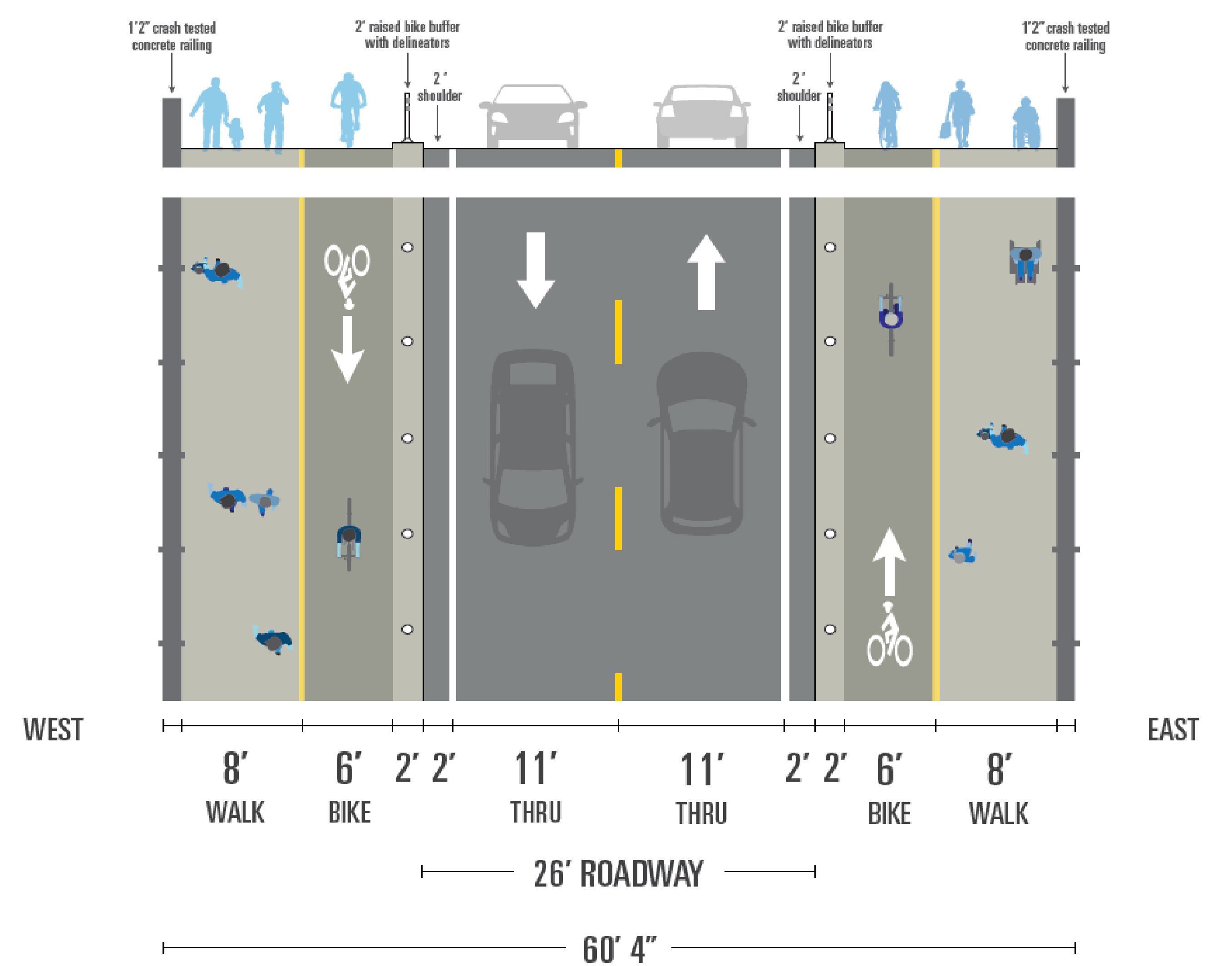

Examples of Similar Protected Bike Lane with Raised Curb and Delineators



Project Contact

Meseret Wolana, City of Minneapolis
Meseret.Wolana@minneapolismn.gov or (612) 673 - 3527



Visit the Project Website

www.minneapolismn.gov/government/projects/nicollet-ave-bridge



Nicollet Ave Bridge over Minnehaha Creek - Historic Bridge Rehabilitation Project -

Bridge Components & Condition

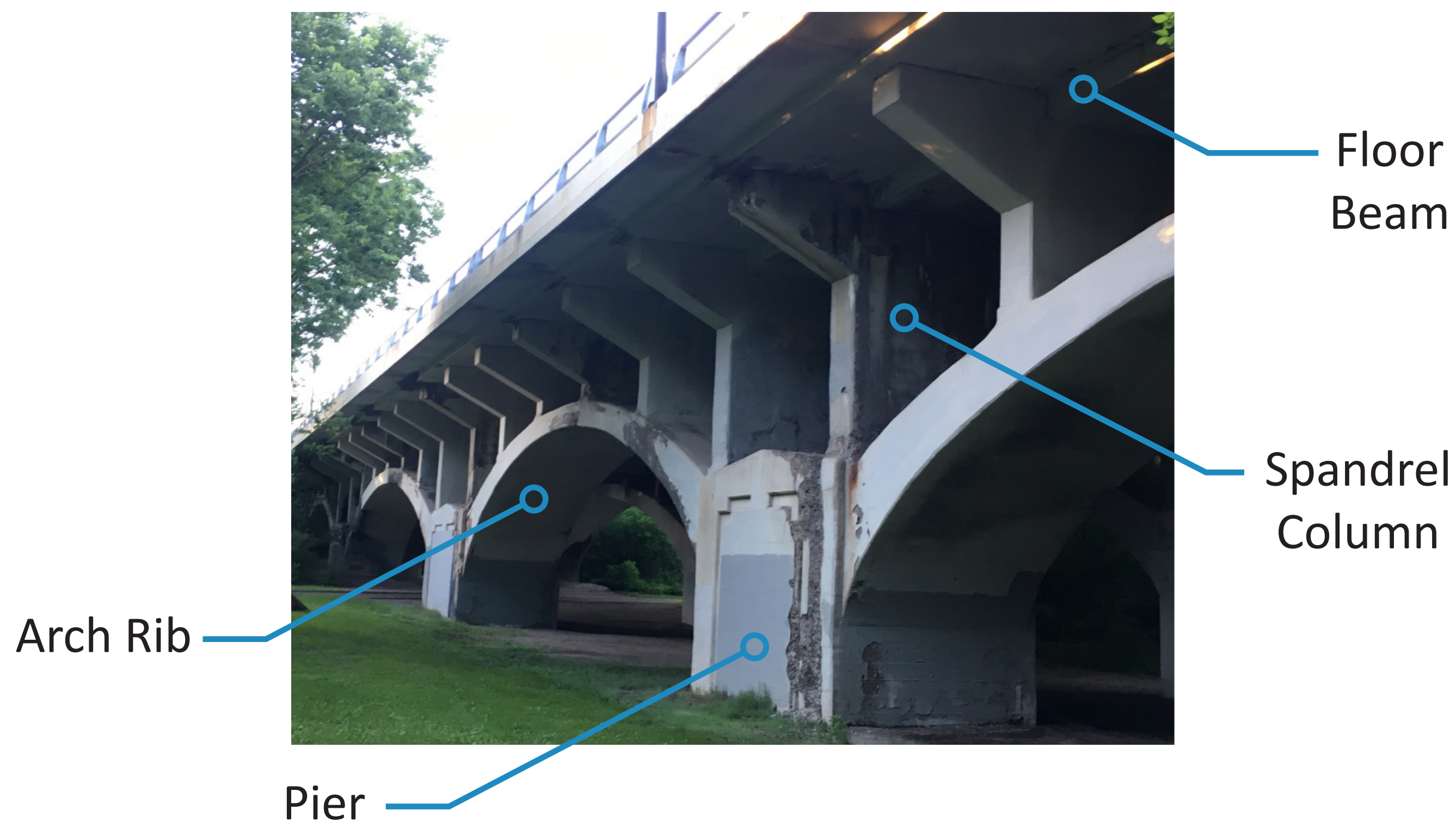

- Leaking deck joints allowed salt-laden water to migrate below and deteriorate the below deck concrete elements
- Significant arch rib cracking and concrete deterioration
- Concrete spalling at the piers from water drainage
- Underside of the deck, spandrel columns, cantilevers and floor beams have significant spalls and cracks at deck joints



Major Crack and Concrete Deterioration on Arch Rib



Cracks and Concrete Spalling on Arch Rib



Additional photos of spalling concrete, exposed rebar, and existing bridge conditions.



Nicollet Ave Bridge over Minnehaha Creek - Historic Bridge Rehabilitation Project -

Proposed Bridge Repairs & Reconstruction (Removals in Red)

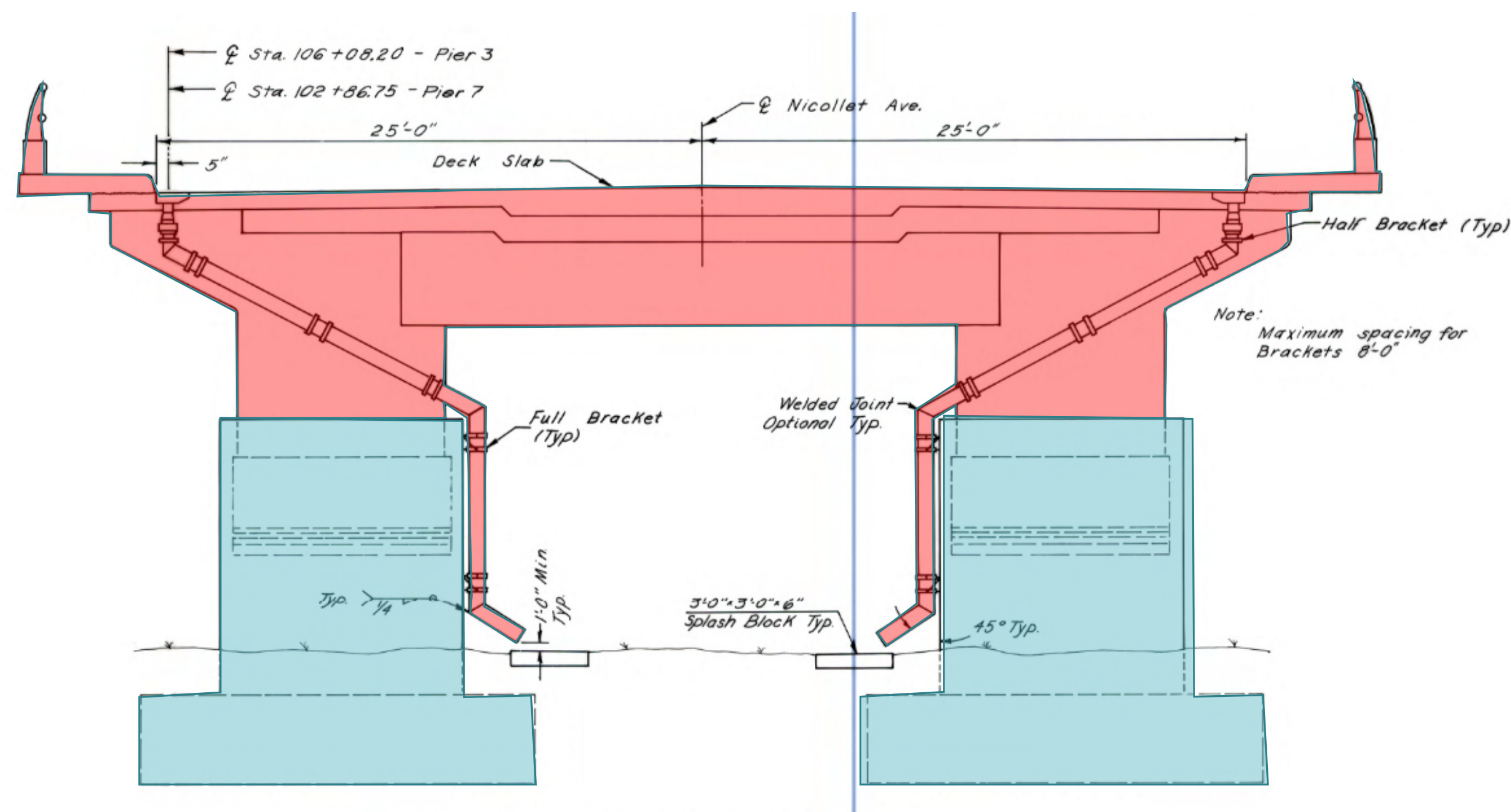

- Remove and replace bridge deck
- Remove and replace all bridge floor beams & spandrel columns
- Reconstruct bridge deck with fewer joints
- Repair concrete surfaces on the arch ribs and piers
- Remove and reconstruct railings and ornamental light poles

Rehabilitated Bridge Elements and New Bridge Deck Components

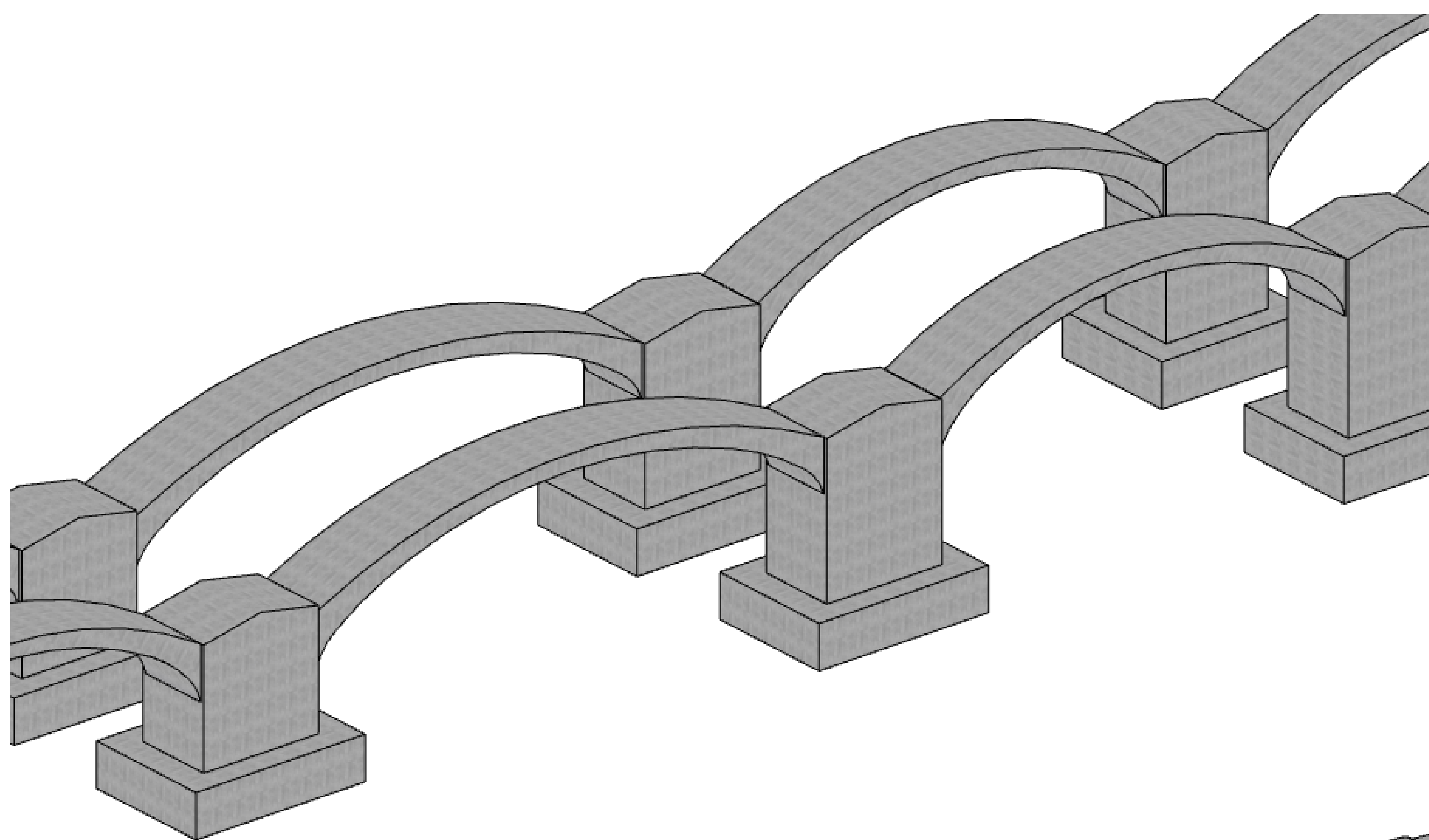

The new design will:

- Provide a new deck with protected bike and walking trails
- Have fewer expansion joints and better protect elements below the roadway
- Strengthens the bridge floor beams
- Have a cathodic protection system to extend the life of the arch ribs

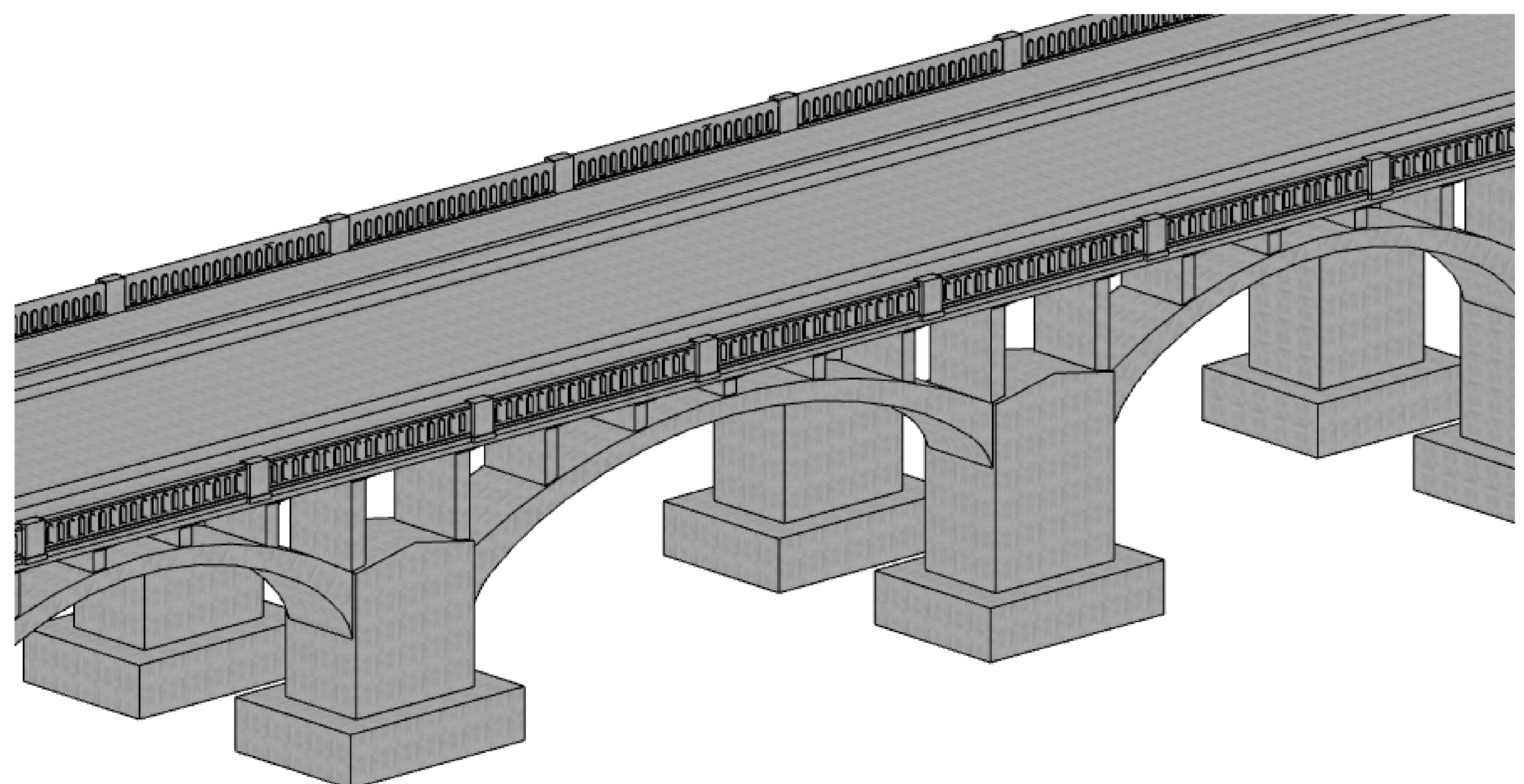

Project Contact

Meseret Wolana, City of Minneapolis
Meseret.Wolana@minneapolismn.gov or (612) 673 - 3527

